



MARSHALL CHESS CLUB REOPENING PLAN

(Revised May, 2021)



INTRODUCTION:

The novel coronavirus, SARS-CoV-2 (“COVID-19”), is extremely contagious and has been declared a worldwide pandemic by the World Health Organization. The Marshall Chess Club (“MCC”) has put in place the preventative measures described in this document, which are consistent with orders, regulations and guidance issued to date by national, state and local authorities, as well as with recommendations to the MCC by independent third parties regarding “best practices”, to prevent or reduce the spread of COVID-19. Such orders, regulations and guidance are subject to change at any time and without notice to or the knowledge of the MCC.

THE MARSHALL CHESS CLUB (“MCC”) CANNOT AND DOES NOT REPRESENT OR GUARANTEE THAT ALL INDIVIDUALS ENTERING MCC’S PREMISES ARE FREE OF COVID-19; THAT ALL SUCH INDIVIDUALS WILL AT ALL TIMES ADHERE TO THE PREVENTATIVE MEASURES MCC HAS PUT INTO PLACE; THAT MCC WILL BE ABLE TO ENFORCE, OR WILL IMPLEMENT, EACH OR ALL SUCH MEASURES AT ANY GIVEN TIME; OR THAT MCC’S IMPLEMENTATION OF SUCH MEASURES WILL IN FACT PREVENT EXPOSURE TO OR INFECTION WITH COVID-19. NOR, BY IDENTIFYING OR IMPLEMENTING THESE MEASURES, DOES ANY OMISSION OR ERROR BY MCC WITH RESPECT TO THEIR IMPLEMENTATION CONSTITUTE NEGLIGENCE BY MCC.



UPDATED:

On March 9th, 2021 the MCC Board of Governor's voted unanimously to reopen the club exclusively for vaccinated club members once there was sufficient vaccinated staff availability.

The MCC reopening plan has been revised to follow the CDC's March 8th, 2021 guidelines for vaccinated persons. The club's reopening will be subject to the protocols outlined in this document, including:

- Members must provide proof of having received a SARS-CoV-2 vaccination before entering the club. Proof will be submitted electronically and members will be approved two weeks after the final injection.*
- The club will only be open to members; therefore only vaccinated members may sign up and play in tournaments.*
- Private lessons will be permitted if both instructor and student provide management advanced proof of having received SARS-CoV-2 vaccinations.*
- A maximum of forty members may be on premises at any time.*

Amended May 25, 2021:

- It is recommended but not required that masks be worn on club premises. The club will disinfect boards, run advanced HEPA units, and open windows when possible.*



STAFF PROTOCOLS

MCC STAFF WILL ADHERE TO THE FOLLOWING:

1. Staff will provide proof of having received a SARS-CoV-2 vaccine before returning to the club.
2. Two staff members will be on duty during tournaments.
3. The office will be limited to one staff member on duty. The second staff member will monitor the door to make sure only members who have registered and provided proof of having received a SARS-CoV-2 vaccine are entering premises.
4. Staff will disinfect the desk area at the start and conclusion of each shift.
5. Stanchions will be placed in front of the office door when the club is open; members will not be permitted in the office.
6. Masks may be worn when moving around the club but it is no longer required (as of May 25, 2021).
7. Personal protective equipment (masks and gloves) will be made available to all employees. (Masks should be changed or washed daily.)
8. Cleaning and sanitizing products will be made available to all employees; Employees shall clean/sanitize touched areas—chess equipment as well as door knobs, bannisters, and hard surfaces—after each use.
9. Bathrooms will be sanitized at the end of each day and over the weekend.
10. Signage will be posted in office to remind employees to adhere to proper hygiene, social distancing rules, appropriate use of PPE, and cleaning/disinfecting protocols.



POLICIES FOR PREMISES

GUESTS & WALK-IN VISITORS WILL NOT BE PERMITTED TO ENTER THE CLUB AT THIS TIME.

MEMBERS WILL BE PERMITTED TO VISIT THE CLUB BY APPOINTMENT ONLY AND MUST PROVIDE PROOF OF HAVING RECEIVED A SARS-CoV-2 VACCINE PRIOR TO THEIR VISIT.

ALL MEMBERS VISITING THE CLUB WILL ADHERE TO THE FOLLOWING RULES OR FACE IMMEDIATE EJECTION.

1. Upload their vaccine card to the newly created member portal before their first visit.
2. **Pre-registration** for a scheduled MCC tournament, class, or other event is required. There will be no onsite or “walk in” registration, casual play, or private lessons.
3. Proper use of a CDC approved mask or facial covering is recommended while on premises. (Amended May 25, 2021.)
4. Cleaning and sanitizing products will be made available to all members; Members shall clean/sanitize touched areas—chess sets, clocks, and boards—after each use.
5. The club will run HEPA units and open windows as much as possible to promote air circulation
6. Signage will be posted at the entry and throughout the club to remind visitors to adhere to proper hygiene, social distancing rules, appropriate use of PPE, and cleaning/disinfecting protocols.



RULES FOR TOURNAMENTS

1. The club capacity will initially be reduced to 50% to allow for social distancing (see the floor plans on the following pages).
2. Members will agree to follow the “Policies for Premises” as outlined above.
3. Members and staff are recommended to wear masks while on premises. (Amended May 25, 2021.)
4. Members must pre-register for tournaments; there will be no “walk in” registration in the club office.
5. Before and after each round, players will be required to spray their chess set with club provided disinfectant spray.
6. Cleaning and sanitizing products will be made available to all players.
7. The club will promote air circulation by opening windows and using filtration devices as much as possible.



FLOOR PLAN (Downstairs)

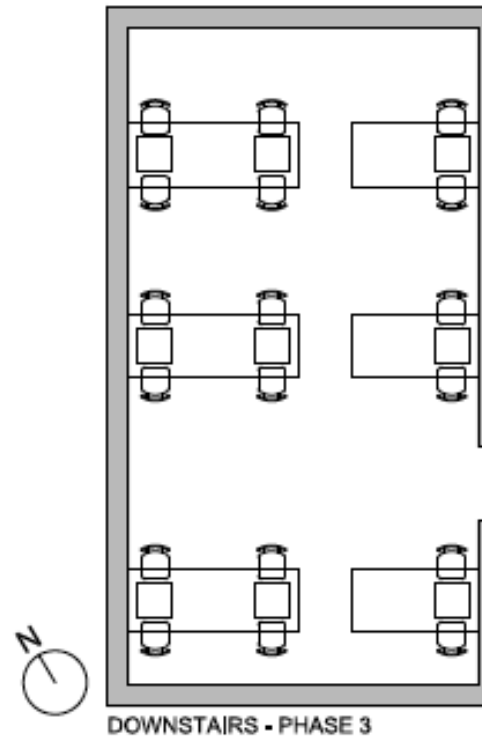
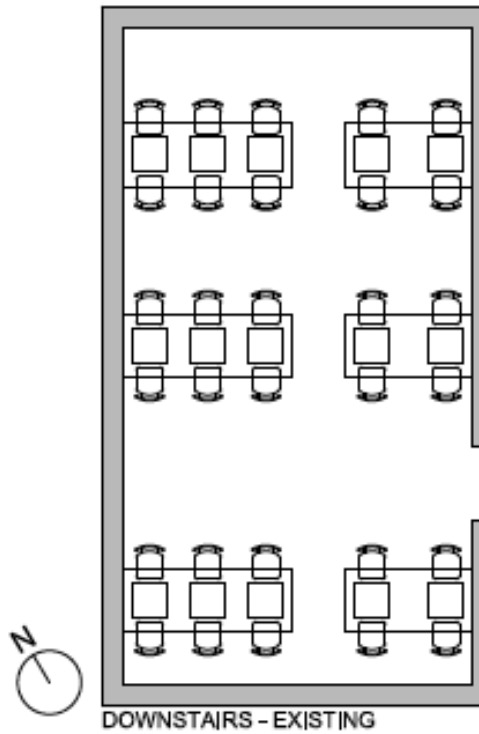



FLOOR PLAN (Upstairs)

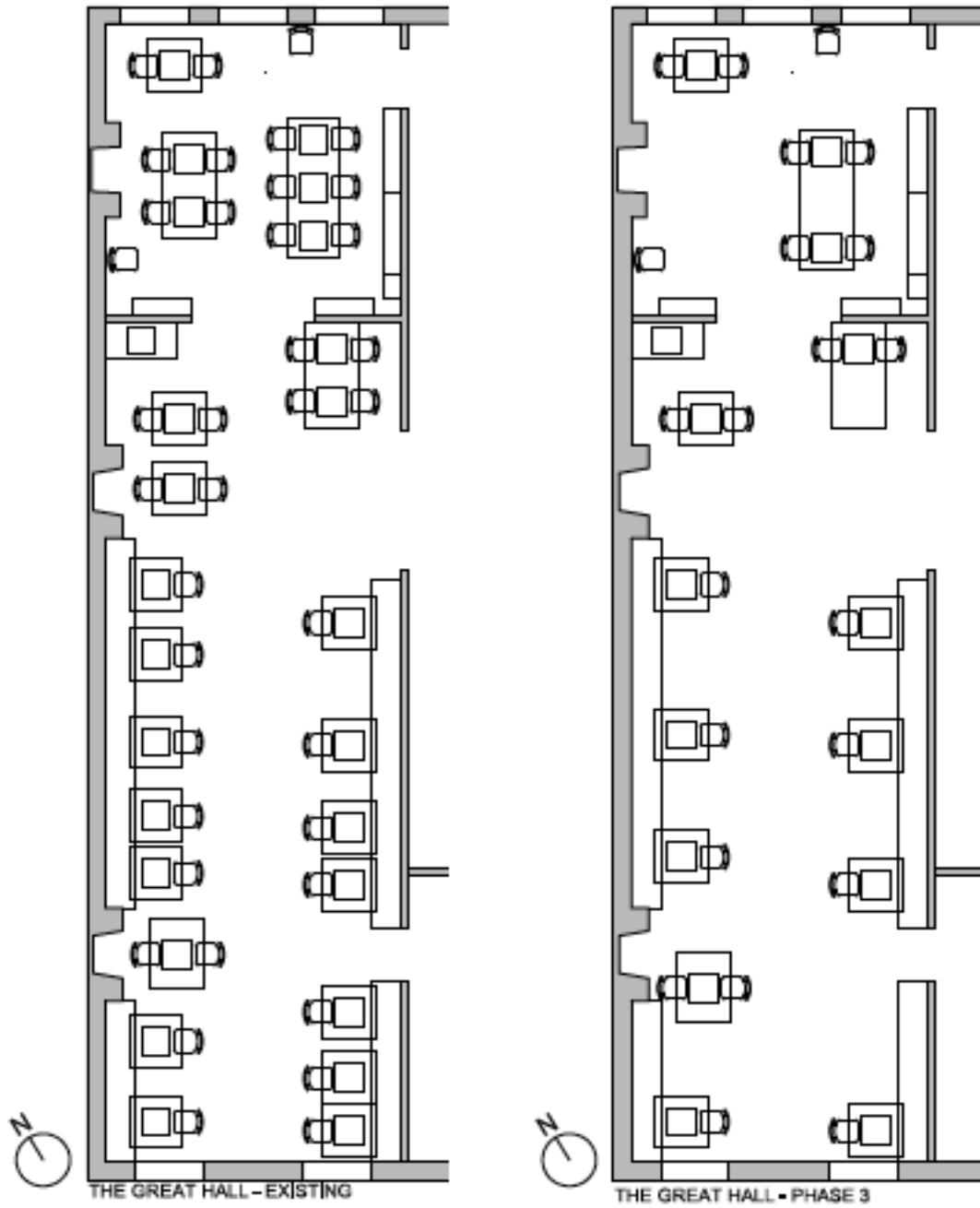

23 West Tenth Street
New York NY 10011
212-477-3716
www.marshallchessclub.org



REOPENING CHECKLIST

ALL OF THE FOLLOWING **MUST** BE COMPLETED
PRIOR TO THE CLUB REOPENING

- Marshall Website must be capable of receiving images of member vaccination cards.
- Plan to approve member cards in database must be designed.
- Plan to only allow club members to register must be designed.
- Three staff members including the Director must be fully vaccinated.
- Air filtration systems must be purchased, installed and test run.
- Email announcement to members announcing re-opening with regulations must be sent.
- Masks and sanitizer must be purchased and made available.
- Signage must be displayed.
- Mark Herman and Bryan Quick must do a walkthrough of the club to address any building issues that might interfere with play.
- Director will hold training with staff members on safety protocols.
- Opening plan should be uploaded onto website.
- Tournament committee should work with Re-Opening Committee to plan events keeping in mind space and that many members will not be eligible during initial phase.